



Dräger



mindray

PHILIPS



Patient
Monitoring
Systems
(PMS)

QUALCOMM LIFE
a Qualcomm company

Dräger



Patient Data
Management
Systems
(PDMS)



PHILIPS

nox medical

Polysomno-
graphic and Poly-
graphic Systems
(PG/PSG)

Air Liquide
HEALTHCARE

BREAS

EOVE





Ventilators

Connectivity

Integrate the SenTec Digital Monitor into your existing infrastructure for efficient patient surveillance and data recording

Patient Monitoring System (PMS)

The SenTec Digital Monitor offers two digital interfaces for robust and reliable data transmission to a wide range of Patient Monitoring Systems.

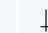
Manufacturer	Devices	Required Software Version	Required SenTec Software Version					
			SMB V07.01.x	SMB V07.02.x	SMB V07.03.x	SMB V08.00.x	SMB V08.01.x	SMB V08.02.x
Dräger	Infinity® Delta		✓	✓	✓	✓	✓	✓
	Infinity® Delta XL		✓	✓	✓	✓	✓	✓
	Infinity® Kappa		✓	✓	✓	✓	✓	✓
	Infinity® Omega Serie		✓	✓	✓	✓	✓	✓
GE Healthcare	Carescape B450	V 2				✓	✓	✓
	Carescape B650	V 1				✓	✓	✓
	Carescape B850	V 1				✓	✓	✓
	Solar 8000 M	V 4A				✓	✓	✓
	Solar 8000 i	V 4E				✓	✓	✓
	Dash 5000	V 3A				✓	✓	✓
Mindray	BeneView T5/T6/T8/T9	5.25 or higher				✓	✓	✓
	BeneVision N12, N15, N17, N19, N22	V2.0 or higher				✓	✓	✓
Philips	IntelliVue MP 40/50/60/70/80/90 or MX 600/700/800 with VueLink Interface	all SW Versions	✓	✓	✓	✓	✓	✓
	IntelliVue MP 40/50/60/70/80/90 or MX600/700/800 with IntelliBridge EC10	H.15 or higher	✓	✓	✓	✓	✓	✓
	IntelliVue MX400/450/500/550 with IntelliBridge EC10	all SW Versions	✓	✓	✓	✓	✓	✓
Spacelabs Healthcare	Spacelabs Flexport System UltraView SL (90442A-03)	v2.00.02EN	✓ 	✓ 	✓ 	✓ 	✓ 	✓ 

 Trend Data are available

✓ PCO2, SpO2, PR

✓ PCO2, PO2, SpO2, PR

PO2 monitoring is only supported if PO2 channel is enabled and OxiVent™ sensor is connected.

* with Retrospective Correction of Residual Drift

Patient Data Management Systems (PDMS)

The SenTec Digital Monitor can be connected to selected Patient Data Management Systems. We are continuously expanding our connectivity options in this area to simplify your patient data management.

Manufacturer	Devices	Required Software Version	Required SenTec Software Version					
			SMB V07.01.x	SMB V07.02.x	SMB V07.03.x	SMB V08.00.x	SMB V08.01.x	SMB V08.02.x
Capsule by Qualcomm Life	DataCaptor™	SenTec A5.02						
Dräger	Integrated Care Manager (ICM)	Version 9.2						
iMDsoft	MetaVision	V5 or higher						
Stowood	Visi – Download	140715 or higher						
TZM	(via) UMG (to GE Healthcare's patient monitors)	V 1.0						

Ventilators

The SenTec Digital Monitor is connectable to ventilators via LAN and serial interface. SenTec's vital parameters are transmitted and displayed in real-time on ventilators.

Manufacturer	Devices	Required Software Version	Required SenTec Software Version					
			SMB V07.01.x	SMB V07.02.x	SMB V07.03.x	SMB V08.00.x	SMB V08.01.x	SMB V08.02.x
Air Liquide	Vendom 30/40	V2.05 or higher						
Breas 	Vivo 45	1.0.26 or higher						
EOVE	EO-150	V 5.0.0 or higher						

Digital Connectivity to Polygraphic and Polysomnographic Systems (PG/PSG)

The digital interfaces on the SenTec monitor allow the transfer of high-resolution data signals to selected PG/PSG systems.

Manufacturer	Devices	Required Software Version	Required SenTec Software Version					
			SMB V07.01.x	SMB V07.02.x	SMB V07.03.x	SMB V08.00.x	SMB V08.01.x	SMB V08.02.x
Cidelec	CID102L, CID102LB	2.2.4 or higher						
	CID-LXe, CID-LXe-206d	2.2.4 or higher						
	CID-LX, CID-LX-206d	2.2.4 or higher						
Nox Medical	NOX A1	1.0.2 3926 or higher						
	NOX C1	1.0.0.69 or higher						
	NOX T3	1.6.0.4208 or higher						

Analog Connectivity to Polygraphic and Polysomnographic Systems (PG/PSG)

SenTec offers a variety of adapter cables to connect PG/PSG systems via an analog interface.

Manufacturer	Devices	SenTec REF
Carefusion	SomnoStar Pro	PSG Cable E
Cidelec	CID102L8-D	PSG Cable P
Compumedics	E-Series	PSG Cable E
	Grael	PSG Cable E
	Siesta	PSG Cable G
	Somte	PSG Cable E
Dr. Fenyves & Gut	SleepDoc: Porti 7 (PG), Porti 8 (PSG)	PSG Cable D
	MiniScreen: PRO (PSG), plus (PG)	PSG Cable D
Natus	Comet/Aurora	PSG Cable E
	Comlab	PSG Cable H
	Deltamed Brain Box	PSG Cable J
	Deltamed Duo 44	PSG Cable H
	Embletta: Gold, MPR PG	PSG Cable L
	Embla: S7000/N7000	PSG Cable A
	Embla Titanium (Isolation Box)	PSG Cable E
	Embla Titanium	PSG Cable K
	Mdrive	PSG Cable N
	TXProxy	PSG Cable N
	PAIB2 interface box	PSG Cable F
Neurovirtual	Sleepvirtual	PSG Cable E
	BWII, BWIII	PSG Cable E
SOMNOmedics	SOMNOscreen	PSG Cable M
Stowood	Visi-3, Visi-System	PSG Cable E
Philips Respironics	Alice 3/4/5/6: square plug	PSG Cable B
	Alice 3/4/5/6: round plug	PSG Cable F
Weinmann_MCC	SOMNOlab, SOMNOlab2	PSG Cable C

Please refer to the SenTec Digital Monitor (SDM) Menu 'Interfaces/Analog Outputs' for 'Channel-to-Parameter' assignment information. For instructions to interface the SDM with polygraphic or polysomnographic systems please refer to the respective manufacturer's instructions for use and to the chapter 'Analog Outputs' in the Technical Manual for the SDM (HB-005752).

The Technical Manual is available as a PDF on our website under <https://www.sentec.com/ifu/>



Wide range of connectivity options

The SenTec Digital Monitoring System (SDM) provides a wide range of connectivity options to bedside monitors, ventilators, PCs, nurse call systems, chart recorders or data loggers. Patient data acquired by the SDM can be output through the multipurpose I/O-port (analog output; nurse call) ❶, the serial data port (RS-232) ❷ or the LAN port ❸, all located on the rear panel of the SDM.

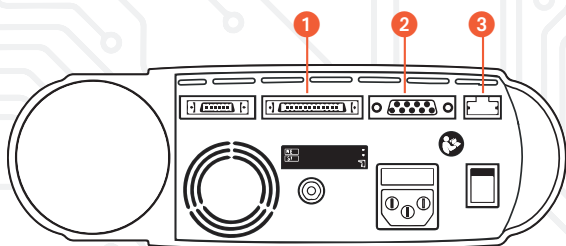

SenTec Connectivity Support Team

We help you get connected

Our dedicated Connectivity Support Team continuously upgrades and expands connectivity options to advance noninvasive patient monitoring and enhance therapy decisions.

If you need any support, please contact your local SenTec representative or send an e-mail to connectivity@sentec.com.

Please visit www.sentec.com for more information.