



Sensor Calibration and Storage

If a sensor calibration is **mandatory**, the SDM displays the message 'Calibrate sensor', a low priority alarm sounds and PCO_2 and PO_2 are marked as 'invalid' (values replaced by '---').



Good to know!

'Calibration Intervals' for SenTec TC Sensors can last up to 12 hours. Once the 'Calibration Interval' has elapsed, sensor calibration is **recommended** (message 'Sensor calibration recommended') and monitoring is possible for another 4 to 6 hours with PCO_2 marked as 'questionable' (p. 33). Thereafter, sensor calibration is **mandatory**.

The SDM, as a precaution, calibrates PO_2 during each mandatory calibration and subsequently approximately once every 24 hours during one of the default PCO_2 calibrations.

To calibrate the sensor:

1. Open the Docking Station Door (7) by pulling the door handle.

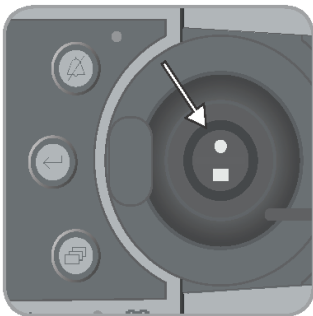

2. Check the gasket (arrow) in the Docking Station. If necessary, clean the Docking Station and gasket by using a cotton swab moistened with 70% isopropanol (for other approved cleaning agents refer to the Technical Manual for the SDM).





! CAUTION: Always clean the sensor before placing it in the Docking Station.

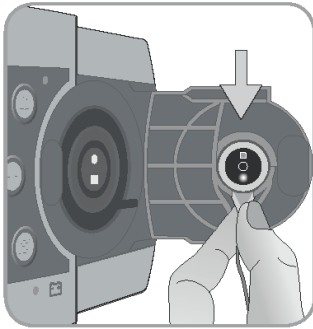

3. Hang the sensor into the holder in the inside of the door. Ensure that the sensor's red light is visible.

! CAUTION: Incorrect orientation of the sensor in the Docking Station may cause damage to the sensor, the Docking Station, or parts thereof when closing the Docking Station door.

4. Close the Docking Station Door. The SDM will check the sensor and – if necessary – start the sensor calibration (message 'Calibration in progress'). The message 'Ready for use' will display once calibration is finished.

! WARNING: Correct calibration requires the sensor to be properly positioned in the Docking Station Door and the Docking Station Door to be closed.

Note: If the sensor is stored in the Docking Station, additional sensor calibrations can be activated via a 'Quick Access Menu' (p. 44). If enabled, PO₂ is also calibrated during calibrations that are activated with the menu-function 'Calibrate sensor'.





WARNING: Transport/store SenTec TC Sensors with membrane and protected from light/radiation. If SenTec TC Sensors are stored without membrane, damage of the sensor may occur. Do not expose the sensor to strong ambient light such as direct sunlight, surgical lamps, infrared warming lamps, and phototherapy lights during clinical use. This may cause inaccurate measurements. In such cases, cover the sensor with an opaque material.

Note: After switching on the SDM or after a membrane change, it is recommended to store the sensor in the Docking Station at least for the duration indicated by the yellow information message 'Recommended Sensor Stabilization [min]:' on the 'Ready for use' screen and on the 'Calibration' screen.

Note: To maintain monitor readiness in-between monitoring, always keep the monitor switched on and always store the sensor in the Docking Station.



Good to know!

SMART CALMEM is a feature of SenTec TC Sensors permitting disconnection of the sensor from the SDM for up to 30 minutes without losing the calibration status. Thus, monitoring can temporarily be interrupted without the need to remove the sensor from the patient, e.g. to untangle cables, to turn or move the patient, or if the patient needs to go to the restroom. Furthermore, SMART CALMEM reduces the number of required calibrations and, hence, the consumption of calibration gas.

